

**FNCE**  
**SLIMLINE**

SLIMLINE PANEL TYPES

6LPOL&WDGDU

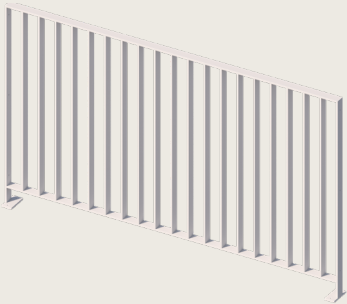

PANEL - 1992mm

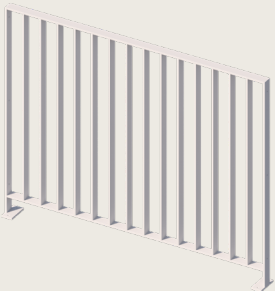

PANEL - 1497mm



PANEL - 1002mm



PANEL - 507mm



PANEL - 309mm



GATE PANEL - 1002mm



END POST



GATE LATCH  
POST

6LPOL&DEGH

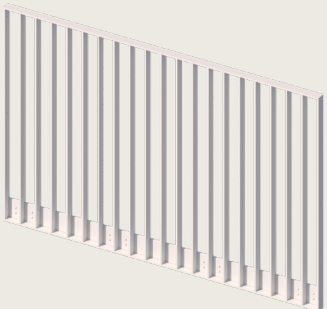

PANEL - 1992mm

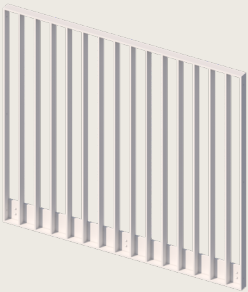

PANEL - 1497mm



PANEL - 1002mm



PANEL - 507mm



PANEL - 309mm



CORNER PANELS



SPACER PANELS  
STRAIGHT

01 – panel types

6LPOL&RUHROH

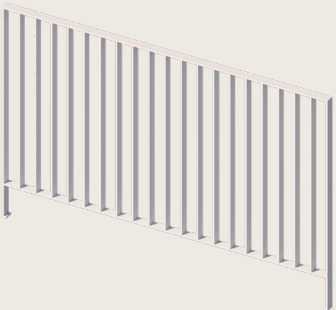

PANEL - 1992mm

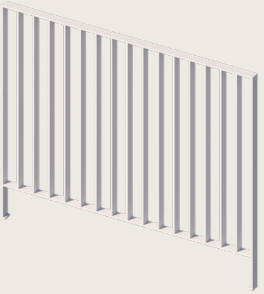

PANEL - 1497mm



PANEL - 1002mm



PANEL - 507mm



PANEL - 309mm

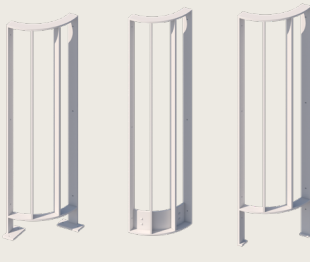

CURVED CORNER PANELS



SPACER PANELS  
ANGLED

© 2022-2024 FNCE Pty Ltd

© 2022-2024 FNCE Pty Ltd



## SLIMLINE PANEL DIMENSIONS

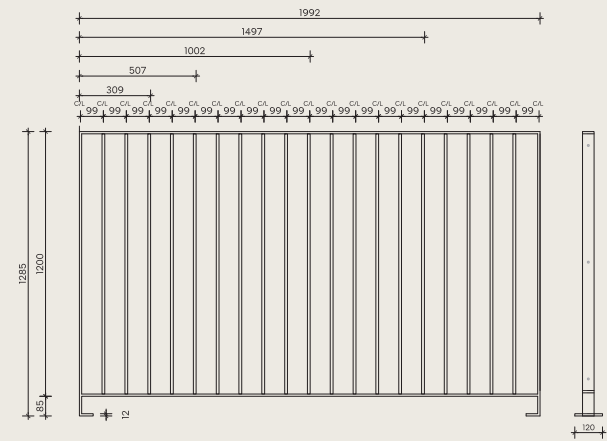

STANDARD PANEL

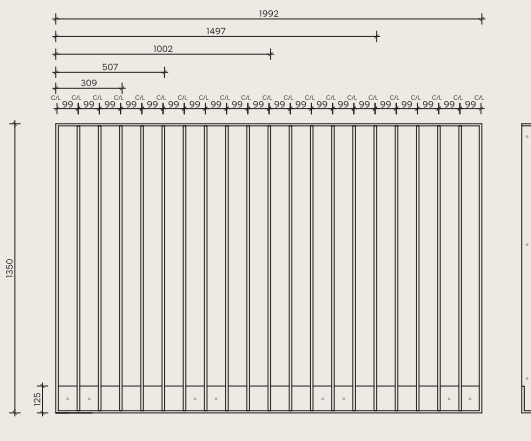

SLAB EDGE PANEL

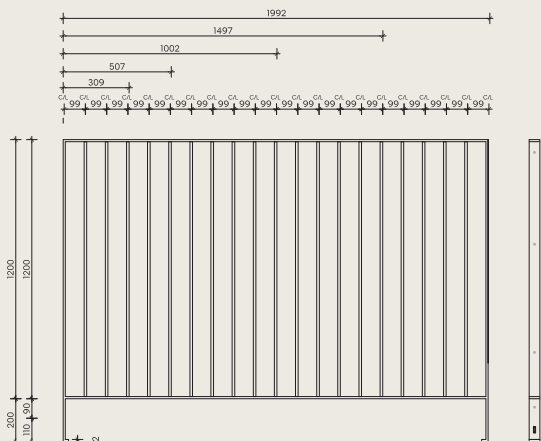

CORE HOLE PANEL

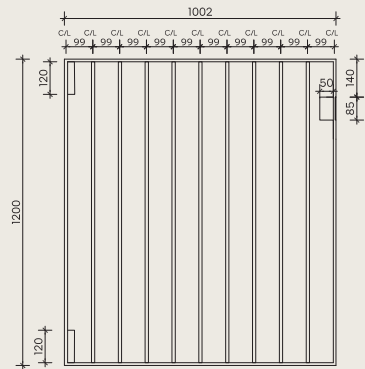

GATE PANEL

### DETAIL 1&2

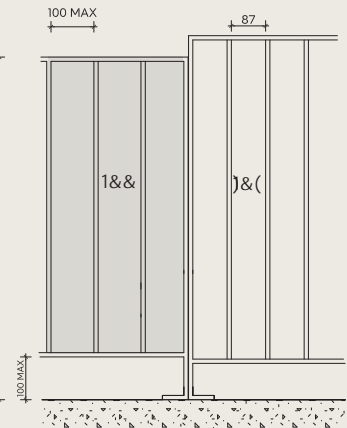

1&2

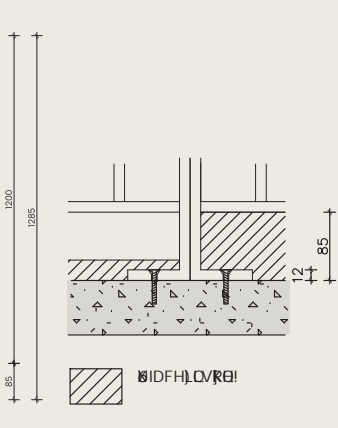

ODL

1&2 3&4 5&6 7&8 9&10 11&12 13&14 15&16 17&18 19&20 21&22 23&24 25&26 27&28 29&30 31&32 33&34 35&36 37&38 39&40 41&42 43&44 45&46 47&48 49&50 51&52 53&54 55&56 57&58 59&60 61&62 63&64 65&66 67&68 69&70 71&72 73&74 75&76 77&78 79&80 81&82 83&84 85&86 87&88 89&90 91&92 93&94 95&96 97&98 99&100 101&102 103&104 105&106 107&108 109&110 111&112 113&114 115&116 117&118 119&120 121&122 123&124 125&126 127&128 129&130 131&132 133&134 135&136 137&138 139&140 141&142 143&144 145&146 147&148 149&150 151&152 153&154 155&156 157&158 159&160 161&162 163&164 165&166 167&168 169&170 171&172 173&174 175&176 177&178 179&180 181&182 183&184 185&186 187&188 189&190 191&192 193&194 195&196 197&198 199&200 201&202 203&204 205&206 207&208 209&210 211&212 213&214 215&216 217&218 219&220 221&222 223&224 225&226 227&228 229&230 231&232 233&234 235&236 237&238 239&240 241&242 243&244 245&246 247&248 249&250 251&252 253&254 255&256 257&258 259&260 261&262 263&264 265&266 267&268 269&270 271&272 273&274 275&276 277&278 279&280 281&282 283&284 285&286 287&288 289&290 291&292 293&294 295&296 297&298 299&300 301&302 303&304 305&306 307&308 309&310 311&312 313&314 315&316 317&318 319&320 321&322 323&324 325&326 327&328 329&330 331&332 333&334 335&336 337&338 339&340 341&342 343&344 345&346 347&348 349&350 351&352 353&354 355&356 357&358 359&360 361&362 363&364 365&366 367&368 369&370 371&372 373&374 375&376 377&378 379&380 381&382 383&384 385&386 387&388 389&390 391&392 393&394 395&396 397&398 399&400 401&402 403&404 405&406 407&408 409&410 411&412 413&414 415&416 417&418 419&420 421&422 423&424 425&426 427&428 429&430 431&432 433&434 435&436 437&438 439&440 441&442 443&444 445&446 447&448 449&450 451&452 453&454 455&456 457&458 459&460 461&462 463&464 465&466 467&468 469&470 471&472 473&474 475&476 477&478 479&480 481&482 483&484 485&486 487&488 489&490 491&492 493&494 495&496 497&498 499&500 501&502 503&504 505&506 507&508 509&510 511&512 513&514 515&516 517&518 519&520 521&522 523&524 525&526 527&528 529&530 531&532 533&534 535&536 537&538 539&540 541&542 543&544 545&546 547&548 549&550 551&552 553&554 555&556 557&558 559&560 561&562 563&564 565&566 567&568 569&570 571&572 573&574 575&576 577&578 579&580 581&582 583&584 585&586 587&588 589&590 591&592 593&594 595&596 597&598 599&600 601&602 603&604 605&606 607&608 609&610 611&612 613&614 615&616 617&618 619&620 621&622 623&624 625&626 627&628 629&630 631&632 633&634 635&636 637&638 639&640 641&642 643&644 645&646 647&648 649&650 651&652 653&654 655&656 657&658 659&660 661&662 663&664 665&666 667&668 669&670 671&672 673&674 675&676 677&678 679&680 681&682 683&684 685&686 687&688 689&690 691&692 693&694 695&696 697&698 699&700 701&702 703&704 705&706 707&708 709&710 711&712 713&714 715&716 717&718 719&720 721&722 723&724 725&726 727&728 729&730 731&732 733&734 735&736 737&738 739&740 741&742 743&744 745&746 747&748 749&750 751&752 753&754 755&756 757&758 759&760 761&762 763&764 765&766 767&768 769&770 771&772 773&774 775&776 777&778 779&780 781&782 783&784 785&786 787&788 789&790 791&792 793&794 795&796 797&798 799&800 801&802 803&804 805&806 807&808 809&810 811&812 813&814 815&816 817&818 819&820 821&822 823&824 825&826 827&828 829&830 831&832 833&834 835&836 837&838 839&840 841&842 843&844 845&846 847&848 849&850 851&852 853&854 855&856 857&858 859&860 861&862 863&864 865&866 867&868 869&870 871&872 873&874 875&876 877&878 879&880 881&882 883&884 885&886 887&888 889&890 891&892 893&894 895&896 897&898 899&900 901&902 903&904 905&906 907&908 909&910 911&912 913&914 915&916 917&918 919&920 921&922 923&924 925&926 927&928 929&930 931&932 933&934 935&936 937&938 939&940 941&942 943&944 945&946 947&948 949&950 951&952 953&954 955&956 957&958 959&960 961&962 963&964 965&966 967&968 969&970 971&972 973&974 975&976 977&978 979&980 981&982 983&984 985&986 987&988 989&990 991&992 993&994 995&996 997&998 999&1000



## SLIMLINE PANEL DIMENSIONS

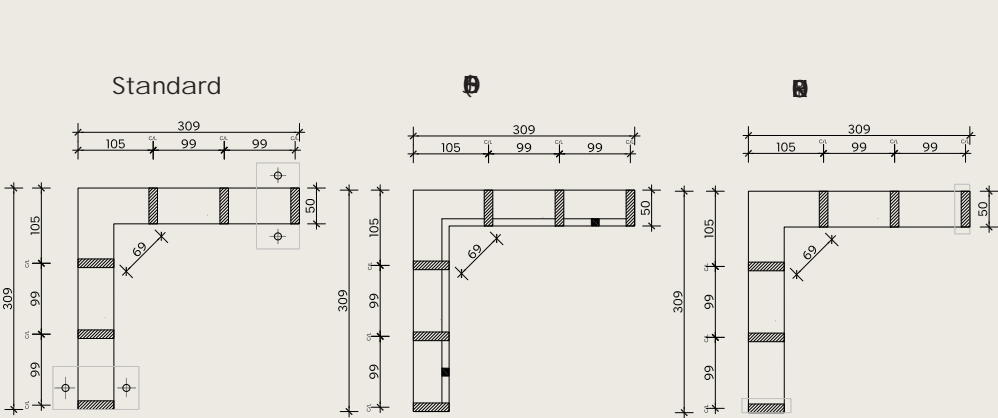

CORNER PANEL

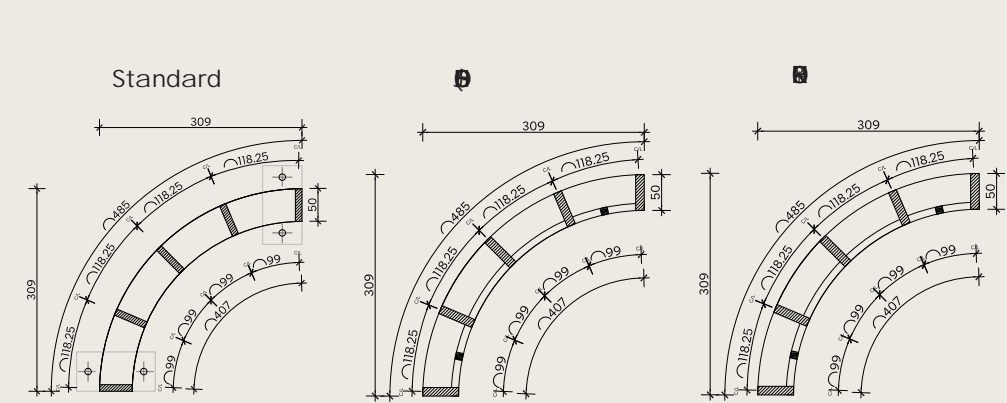
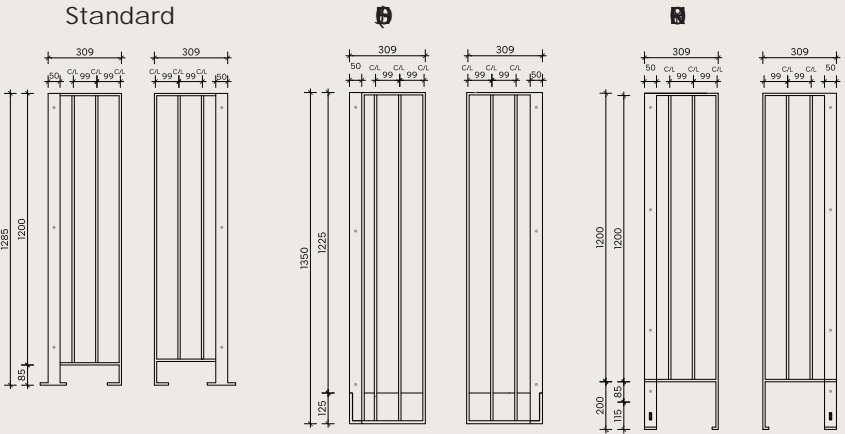

CORNER PANEL

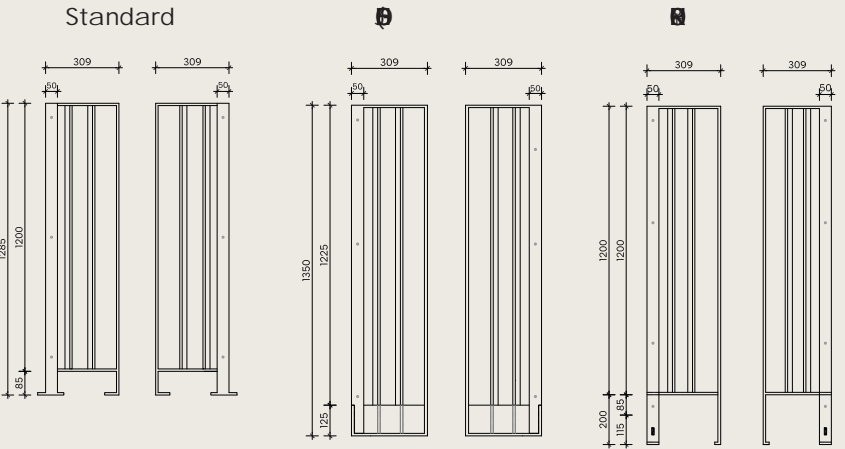

## SYSTEM INSTALL

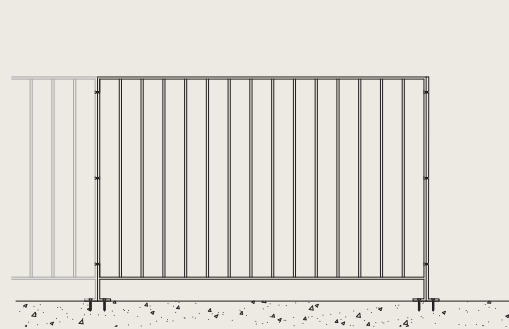

DETAIL | Standard

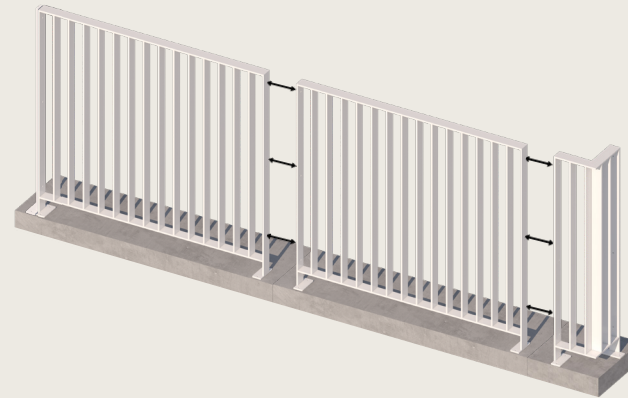

DETAIL | D E H G H

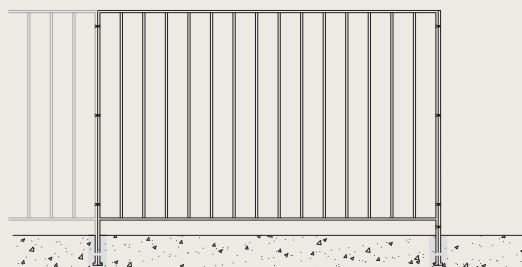
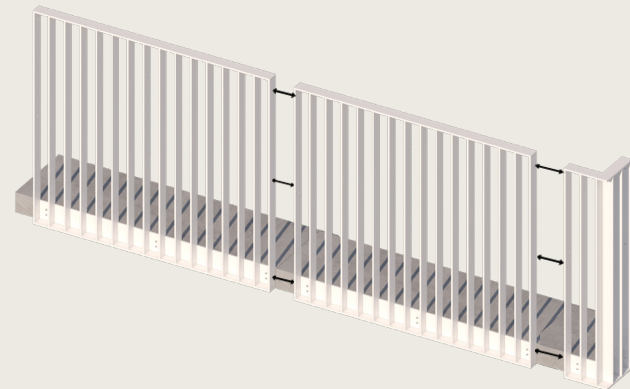
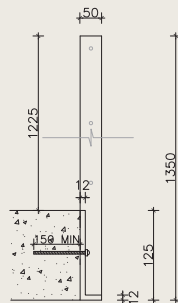

DETAIL | & R U H R O H

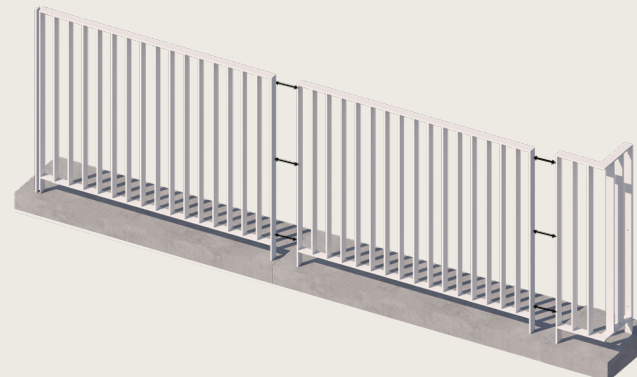

1RWHWDGDUGDQ&RUHROHSD&BOWSHV  
DUH&WUHHVWDGLD

7KRXWEHLWDWDOOHGZWKILWKUDQ  
DGMRLD&H3D&O25Q3RVW25  
DWH&WFG3RVW25&RU&U&VHPEO\  
LQWDOOHGR&DFKQ

Installer to confirm engineer / statutory and local regulatory compliance requirements prior to ordering to ensure compliance for your specific application.

Drawings and measurements provided as a guide only and should not solely be relied upon for your project.



BASE PLATE FIXING DETAILS

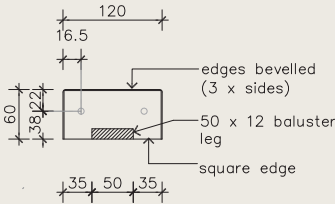

DETAIL | 2VH3ODWH60H

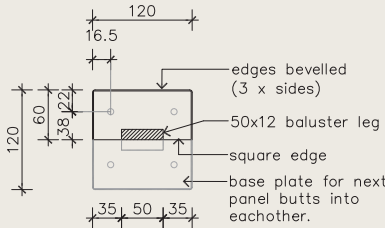

DETAIL | 2VH3ODWHRXOH

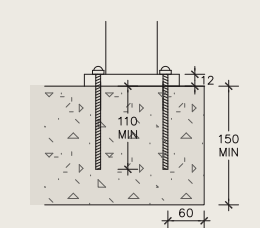

' ( 7 \$ , / Ø % \$ 6 ( 3 / 7  
Top of Slab

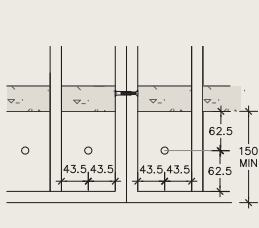

7\$ 8 ( 3D80  
&R6FWLRQDBOWR

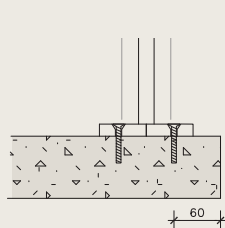

7\$ 8 ( 3D80  
( GHGLVWDBHV

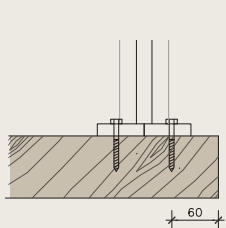

| DETAIL 1   | DETAIL 2   | DETAIL 3  | DETAIL 4   | DETAIL 5   | DETAIL 6  | DETAIL 7   |
|--|--|---|--|--|---|--|
|  |  |   |  |  |   |  |
| <p>Class 'C' Non Shrink Cementitious Grout installed in accordance with manufacturer's recommendations and guidelines. Brand / Supplier to the installers recommendations.</p> | <p>M10 Fischer Ultracut FBS II concrete screws. Min 85mm embedment. OR<br/>M8 Hilti HSL4 Expansion anchors with 80mm embedment OR<br/>M10 s.s. rods with Chemset 801 with 110mm embedment.</p> | <p>M8 Bolt through connection with a 50x50x3 s.s. washer to the Nyloc Nuts OR 0 6 W D L Q O H V V \$ &amp; R X Q W H U V X Q N &amp; R M10 s.s. rods with Chemset 801 with 110mm embedment.</p> | <p>M10 Fischre Ultracut FBS II concrete screws Min 85mm embedment OR M8 Hilti HSL4 Expansion anchors with 80mm embedment OR M10 s.s. rods with Chemset 801 with 110mm embedment.</p> | <p>M12 Bolt through connection with a 50x50x3 s.s. washer to underside Nyloc nuts OR M10 Stainless A4-70 G316 Countersunk Screw Min 110mm embedment.</p> | <p>M10 Fischre Ultracut FBS II concrete screws Min 85mm embedment OR VM8 Hilti HSL4 Expansion anchors with 80mm embedment OR M10 s.s. rods with Chemset 801 with 110mm embedment.</p> | <p>M12 Bolt through connection with a 50x50x3 s.s. washer to Nyloc nuts OR M10 Stainless A4-70 G316 Countersunk Screw Min 110mm embedment.</p> |
| ' ( 7 \$ , / Ø % \$ 6 ( 3D80<br>Core Hole Installation   | ' ( 7 \$ , / Ø ( 1 ' 3D80<br>Concrete & Timber Walls   | ' ( 7 \$ , / Ø % \$ 6 ( 3D80<br>Surface Mount   | ' ( 7 \$ , / Ø % \$ 6 ( 3D80<br>Edge   | ' ( 7 \$ , / Ø % \$ 6 ( 3D80<br>Edge   | ' ( 7 \$ , / Ø % \$ 6 ( 3D80<br>Edge  | ' ( 7 \$ , / Ø % \$ 6 ( 3D80<br>Edge   |



## SPACER PANELS, PANEL CONNECTION & TYPICAL WELDING DETAILS

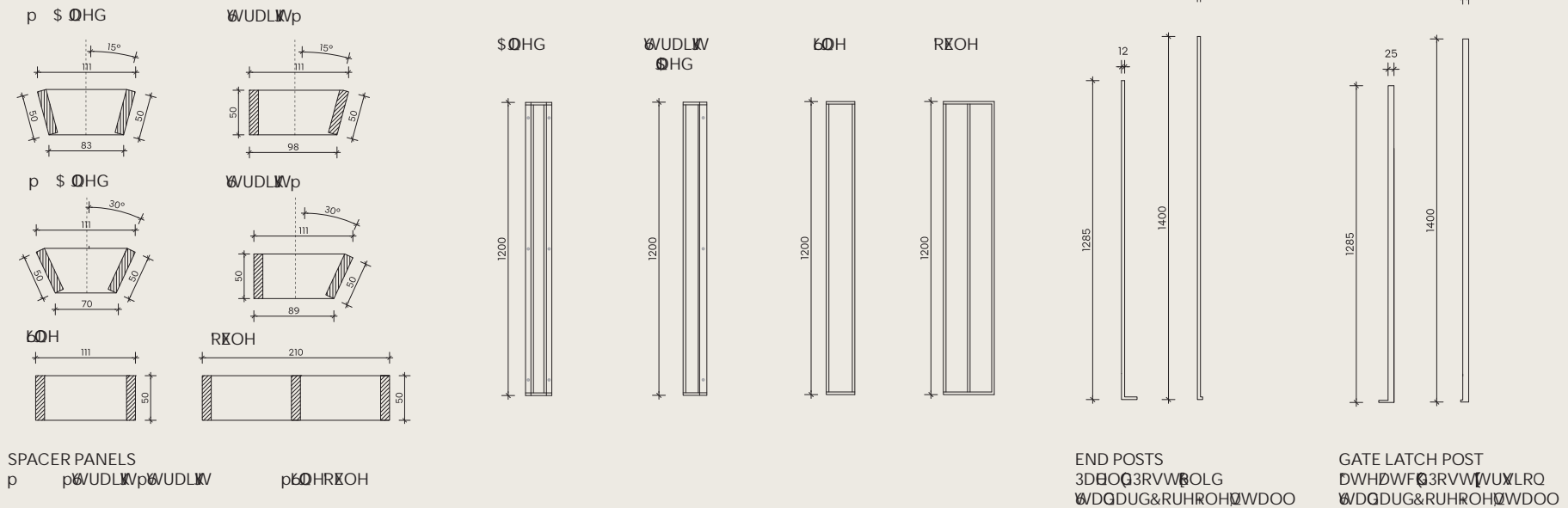

### TYPICAL WELD DETAILS

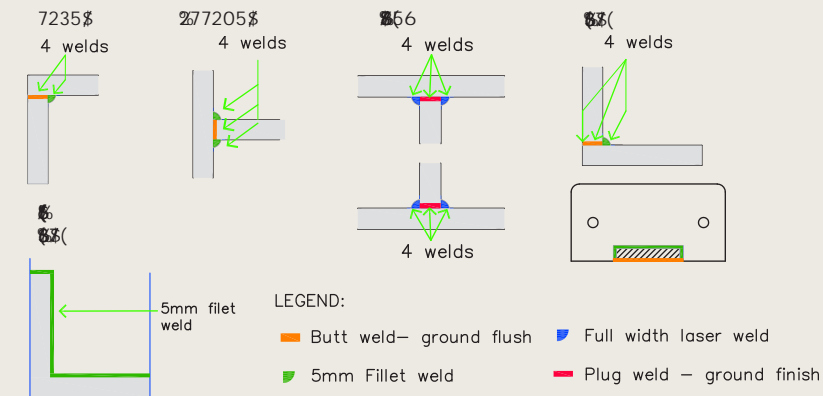

### PANEL CONNECTION BOLTS

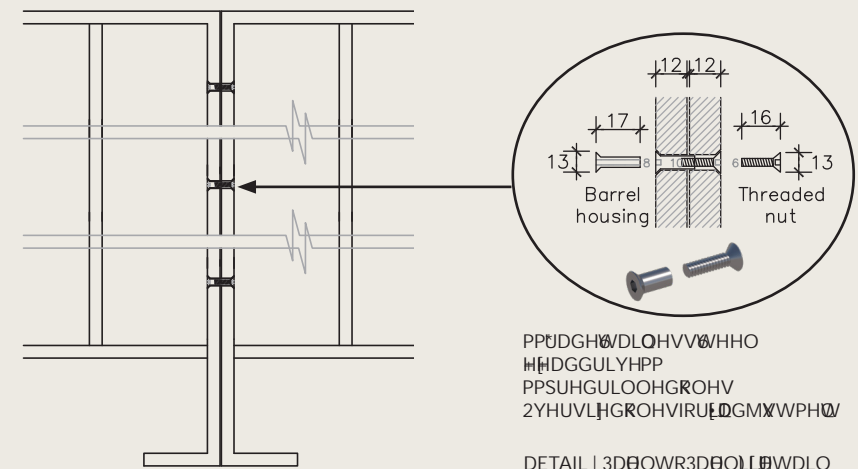

## GATE LATCH CONNECTION & FIXING DETAILS

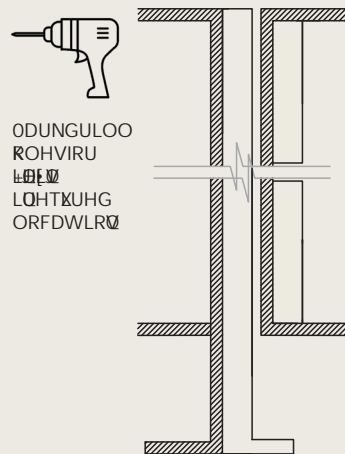
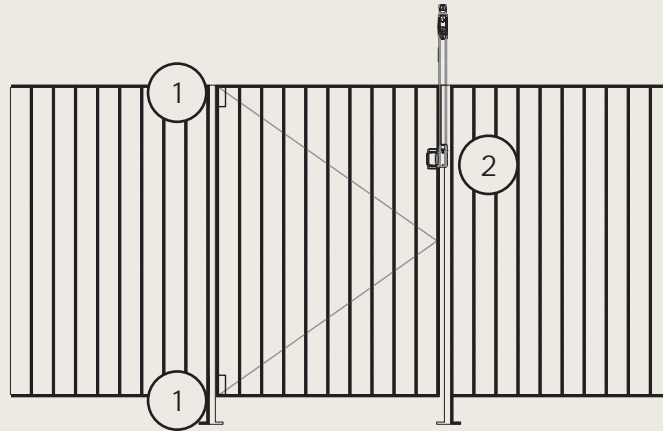

ODUNGULOO  
ROHVIRU  
LOHT&UHG  
ORFDWLRQ

1 DETAIL | DWHLVDWHDF&RVV

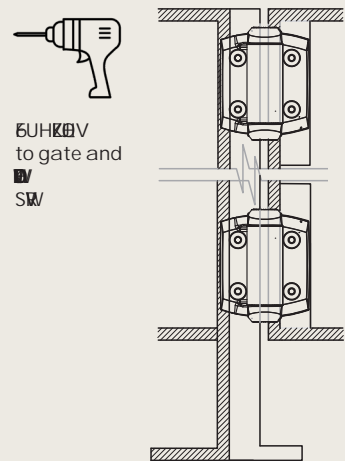

BUH&V  
to gate and  
SW

Maintain  
SD  
A/

1 DETAIL | DWDOODWLRQ

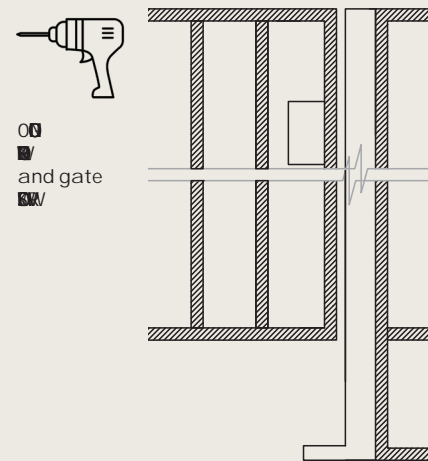

OO  
and gate  
SW

2 DETAIL | DWHDWF&WHDFK  
3RVW



Screw gate  
SW

2 GATE LATCH | DWHDWF&WDOODWLRQ

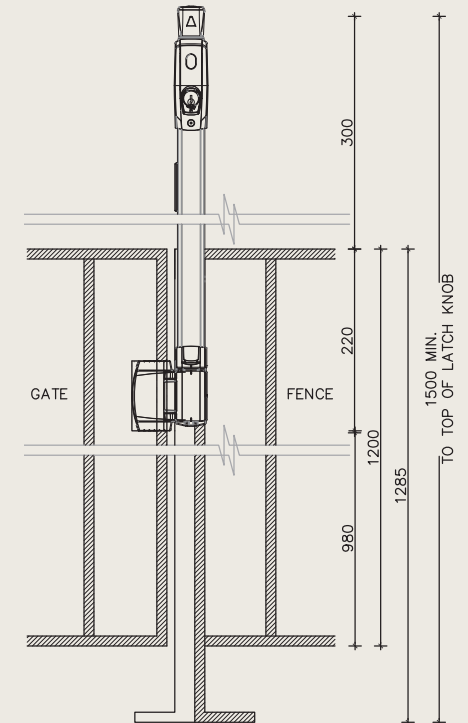

RECOMMENDED GATE LATCH & HINGE  
ODDODWF&ULHV7RS3&OORGH00737UKRUH5H&DU7&8  
QWDOOX&V&SOLHGIURPK&PD&FW&HU  
S&L&DWF&Q&DWHDF&FHVVRULHV&DUH&WREHL&QWDOOH&G&ZW&K&PD&FW&HU&n&V&QWDOODWLRQ&CHOLE&VD&GUHFRPPH&Q&DWLRQ  
S&L&DWF&Q&DWHVDF&FHVVRULHV&WREHL&QWDOOH&GL&D&FRUG&D&H&ZW&P&L&R&RO&VD&H&W&D&G&DUG&H&W





MORZVDWDEOHWRSURYLGHXGDCHIRUWKFRUUHFW)&\$DBOVVWHPDQVLHWRPHHWRMSURMHFWVGHVLQHTKUHPHVV  
YLVVWKUHVSRQLELOLWRIWKIRBULQWDOOHUWRHQQHWKIDSSURSULDWH)&VWHPLVLQWDOOHGIRUWKFRUUHFWEKOGLOVSHDQXH  
5HIHUWRRXORFDODXVRULWLHVHDDHUDEKOGLOHULWLUWRHQQHWKULVSURGFWLVVHOHFWHGIRURXDSSOLFDWLRO

| )&QLPOLBVDGDUGWRSFGSDBOVLHVLPPIRUYDULRXORDGFDVHV |       |     |    |    |      |      |      |      |     |     |    |     |
|--|-------|-----|----|----|------|------|------|------|-----|-----|----|-----|
|  | 3RRO1 | \$P | WP | 1P | \$P  | WP   | &1P  | 1P   | &1P | &1P | 1P | &1P |
| HWWLPEHU--                                       |       |     |    |    | 1002 | 1002 | 1002 | 1002 |     |     |    |     |
| W/   |       |     |    |    | 1002 | 1002 | 1002 | 1002 |     |     |    |     |
| USD  |       |     |    |    | 1002 | 1002 | 1002 | 1002 |     |     |    |     |
| )  |       |     |    |    |      |      |      |      |     |     |    |     |
|  | B     | \$P | WP | 1P | \$P  | WP   | BP   | 1P   | BP  | BP  | 1P | BP  |
| W/   |       |     |    |    |      |      |      |      |     |     |    |     |
| W/   |       |     |    |    |      |      |      |      |     |     |    |     |
| USD  |       |     |    |    |      |      |      |      |     |     |    |     |
| )  |       |     |    |    |      |      |      |      |     |     |    |     |
|  | B     | \$P | WP | 1P | \$P  | WP   | BP   | 1P   | BP  | BP  | 1P | BP  |
| USD  |       |     |    |    |      |      |      |      |     |     |    |     |



# FNCE

[fnce.com.au](https://fnce.com.au)

© 2022-2024 FNCE Pty Ltd

