

FNCE
TUBE

TUBE PANEL TYPES

ACCESSORY PIECES

Tube Standard

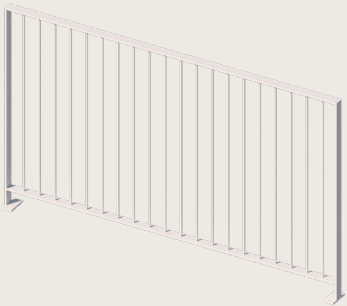

PANEL - 2013m

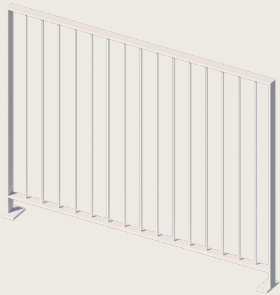

PANEL - 1491mm



PANEL - 969mm



PANEL - 534mm



PANEL - 273mm



GATE PANEL - 1002mm

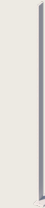

END POST



GATE LATCH POST

Tube Slab Edge

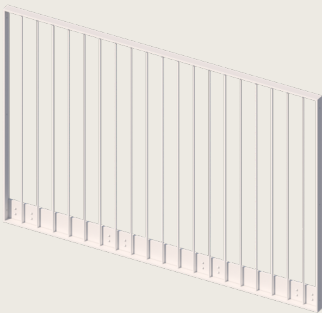

PANEL - 2013mm

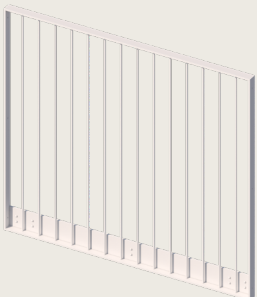

PANEL - 1491mm

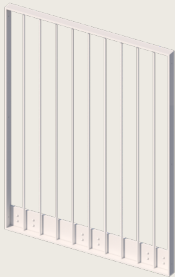

PANEL - 969mm



PANEL - 534mm



PANEL - 273mm

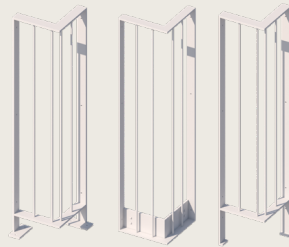

CORNER PANEL



SPACER PANELS STRAIGHT

Tube Core Hole

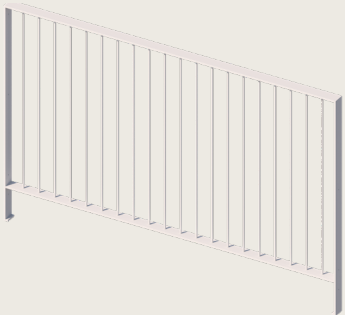

PANEL - 2013mm



PANEL - 1491mm

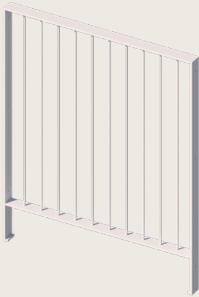

PANEL - 969mm



PANEL - 534mm



PANEL - 273mm

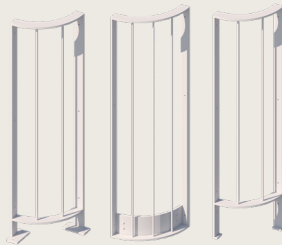

CURVED CORNER PANEL



SPACER PANELS ANGLED

01 – panel types



Pearl White - Gloss
-YA075A



Black Satin- Satin
-YN167A



TUBE PANEL DIMENSIONS

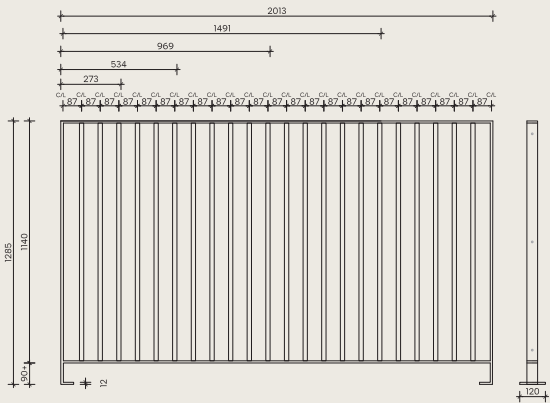

STANDARD PANEL

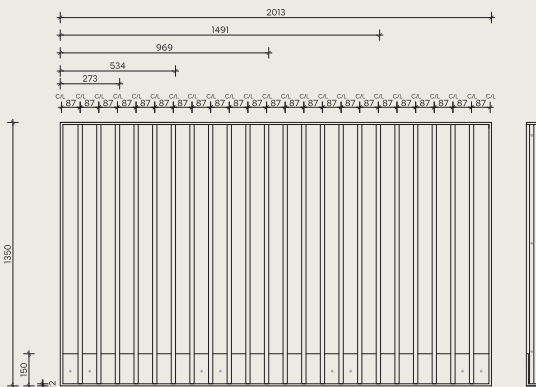

SLAB EDGE PANEL
PPPPPPPPPP:
OLDPRUVPPIRIR
1RIR

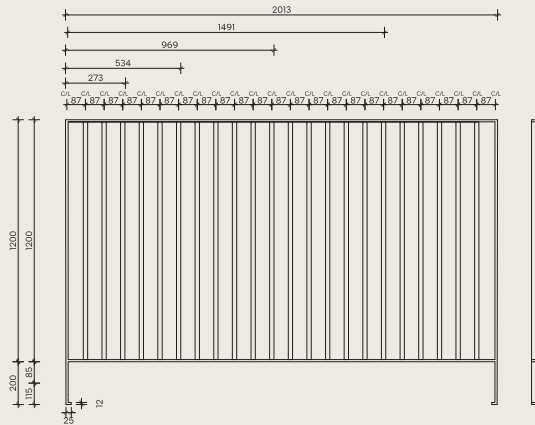

CORE HOLE PANEL
PPPPPPPPPP:
OLDPRUVPPIRIR
1RIR

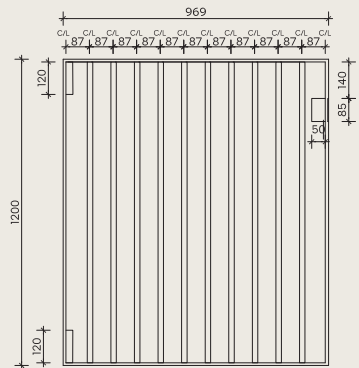

GATE PANEL
PPPP:

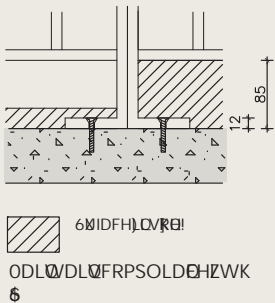
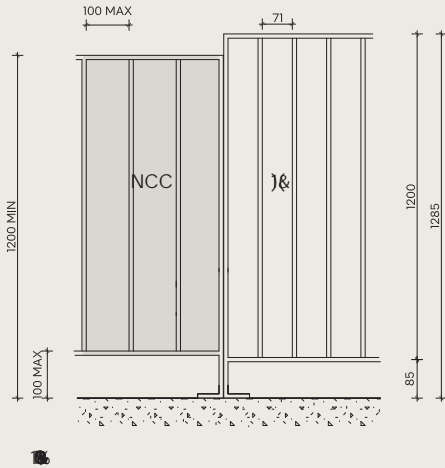

HVLGLDFFRUGDCHZW661&9RORHV66
WHVWHGDGFHUWLFDWLRWR66ZPPLORRO6DIHW6WDGDUGV6HW7HVVWLDGFHUWLFDWLRWR61=

ISDØGLPHØLRØGHWDLOW



TUBE PANEL DIMENSIONS

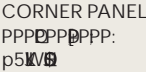
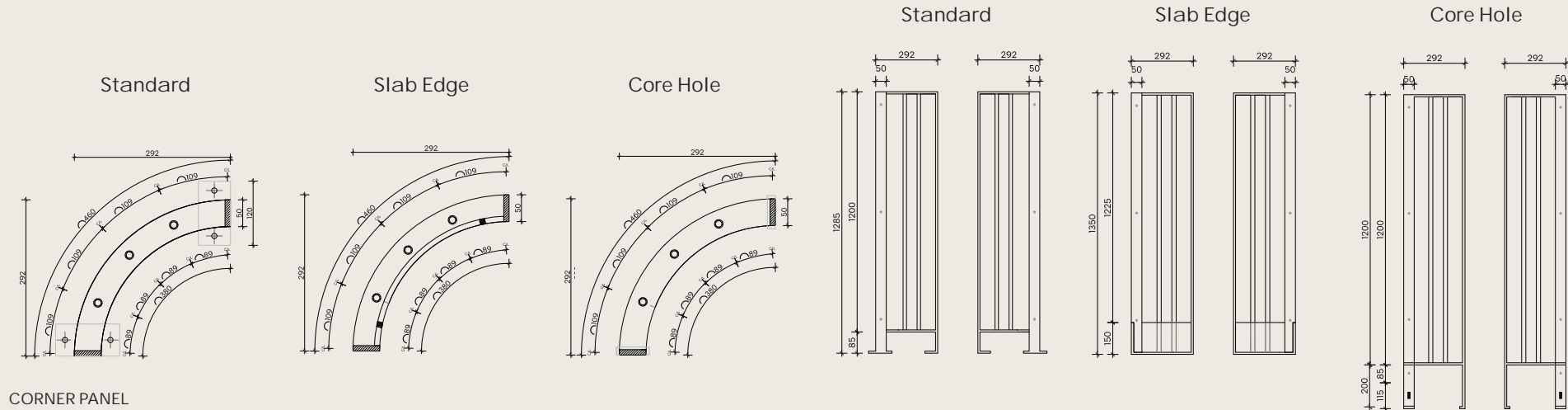
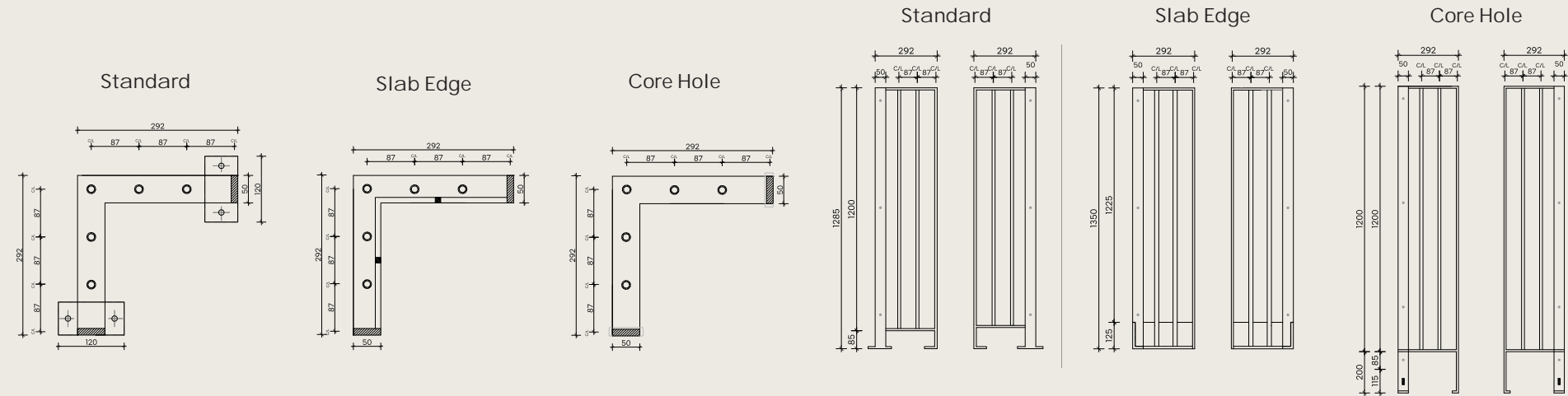

SYSTEM INSTALL OPTIONS

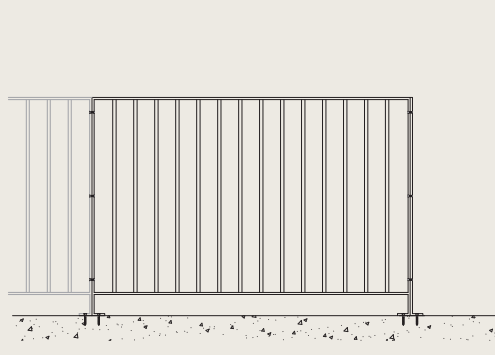

DETAIL | Standard

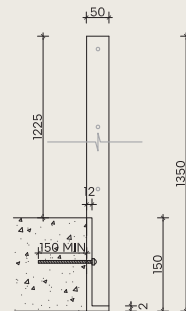
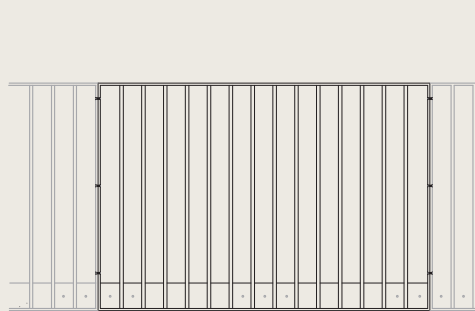
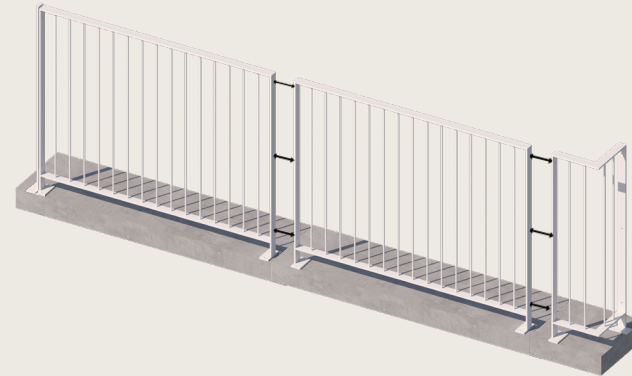

DETAIL | Slab edge

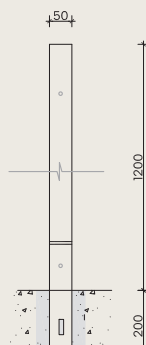
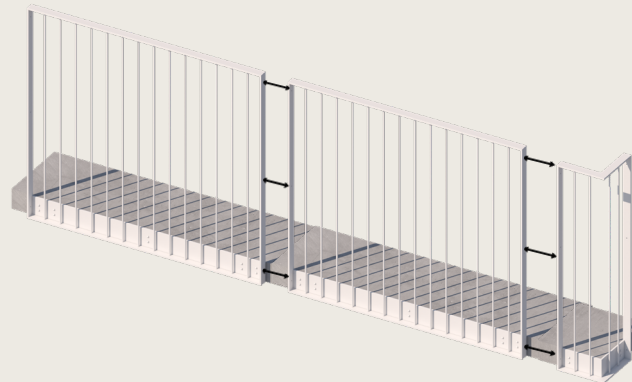

DETAIL | Core Hole



1WH6W0000SBW/SHV
BQ/HWQD

7KRWEHWDGZVKWKD
GM00025QW/25
DWHWDW/250MPEO
W0G000

Installer to confirm engineer / statutory and local regulatory compliance requirements prior to ordering to ensure compliance for your specific application.

Drawings and measurements provided as a guide only and should not solely be relied upon for your project.



Technical drawings of two baluster end views, labeled 'a' and 'b'.

View a: Shows a baluster with a 50x12 leg, bevelled edges (3 sides), and a square edge. Dimensions include 120, 16.5, 60, 38, 24, 35, 50, and 35.

View b: Shows a baluster with a 50x12 leg, bevelled edges (3 sides), a square edge, and a base plate for the next panel. Dimensions include 120, 16.5, 60, 38, 24, 35, 50, and 35.

DETAIL | 21VH3ODWHRXOH

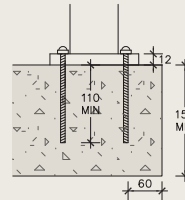

'(7\$, / Ø % \$ 6 (3Top\$ 7 (
of Slab

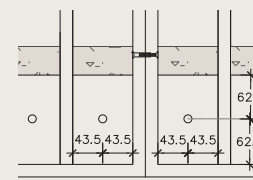

7\$ 6%
Connection Panel to
Panel

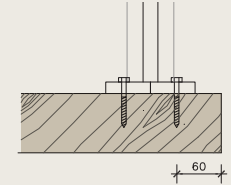
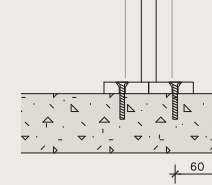

7\$ 88(| Edge distances

DETAIL 1	DETAIL 2	DETAIL 3	DETAIL 4	DETAIL 5	DETAIL 6	DETAIL 7
<p>Class 'C' Non Shrink Cementitious Grout installed in accordance with manufacturer's recommendations and guidelines. Brand / Supplier to the installers recommendations.</p>	<p>M10 Fischer Ultracut FBS II concrete screws. Min 85mm embedment. OR M8 Hilti HSL4 Expansion anchors with 80mm embedment OR M10 s.s. rods with Chemset 801 with 110mm embedment</p>	<p>M8 Bolt through connection with a 50x50x3 s.s. washer to X Q G H U V L G H • [H G Nyloc Nuts OR M10 Stainless A4-70 G316 Countersunk Coach Screw Min. 110 embedment</p>	<p>M10 Fischre Ultracut FBS II concrete screws Min 85mm embedment. OR M8 Hilti HSL4 Expansion anchors with 80mm embedment OR M10 s.s. rods with Chemset 801 with 110mm embedment</p>	<p>M12 Bolt through connection with a 50x50x3 s.s. washer to X Q G H U V L G H • [H G Nyloc nuts OR M10 Stainless A4-70 G316 Countersunk Screw Min 110mm embedment</p>	<p>M10 Fischre Ultracut FBS II concrete screws Min 85mm embedment. OR M8 Hilti HSL4 Expansion anchors with 80mm embedment OR M10 s.s. rods with Chemset 801 with 110mm embedment</p>	<p>M12 Bolt through connection with a 50x50x3 s.s. washer to X Q G H U V L G H • [H G Nyloc nuts OR M10 Stainless A4-70 G316 Countersunk Screw Min 110mm embedment</p>
<p>' (7\$, / Ø % \$6 (3067Hole Installation</p>	<p>' (7\$, / Ø (1' 3267Masonry & Timber Walls</p>	<p>' (7\$, / Ø % \$6 (3067Surface Mount</p>	<p>' (7\$, / Ø % \$6 (3067Slab Edge</p>	<p>' (7\$, / Ø % \$6 (3067Slab Edge</p>	<p>' (7\$, / Ø % \$6 (3067Slab Edge</p>	<p>' (7\$, / Ø % \$6 (3067Slab Edge</p>

[illegible]

p Angled **6W/p**

111
15°
50
83

p Angled **6W/p**

111
15°
50
98

p Single **6W/p**

111
30°
50
70

p Single **6W/p**

111
30°
50
89

Single

111
30°
50
70

Single **6W/p**

111
30°
50
89

p p6WUDLV p6WUDLV 60p6WUDLV

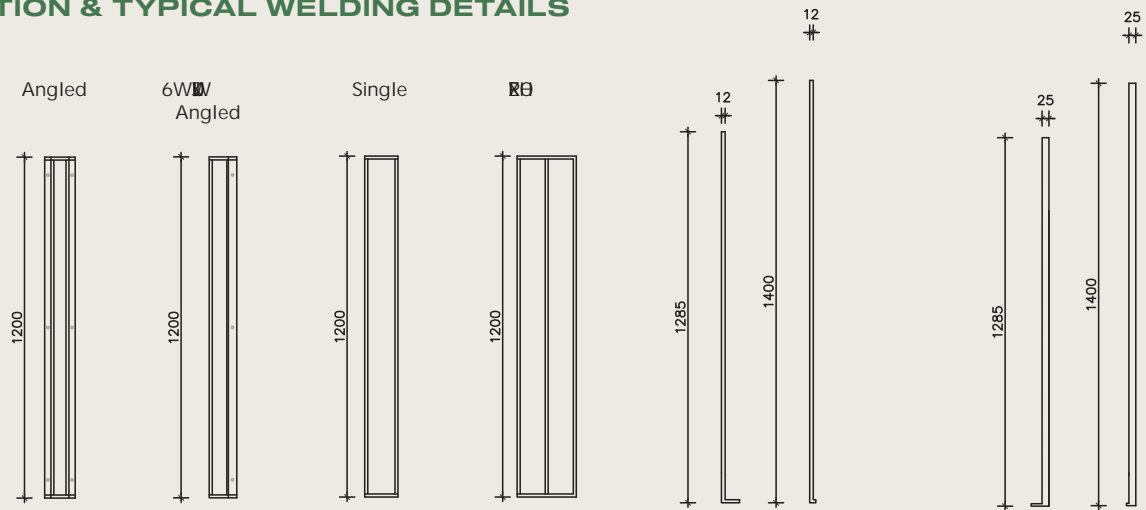

GATE LATCH POST
DWHDWFO3RVWVWUXLRQ
6WDGDUG&RUHROHQZWDQOO

7235S
4 welds

7205S
4 welds

756
2 welds

83
4 welds

6mm
83

5mm fillet weld

LEGEND:

- Buttt weld - ground flush
- Full width laser
- 5mm Fillet weld
- Plug weld - g

LEGEND:

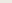
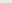
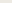
 Butt weld— ground flush	 Full width laser weld
 5mm Fillet weld	 Plug weld – ground finish

The diagram shows a three-phase transmission line with three horizontal conductors. A series capacitor is connected between the middle and right conductors. A shunt reactor is connected between the middle conductor and ground. The diagram is labeled with 'a', 'b', and 'c' for the phases and 'g' for ground.

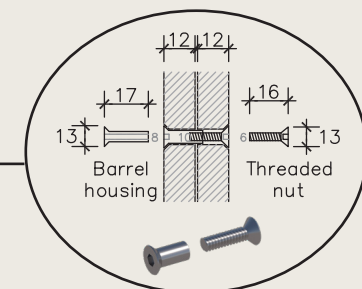

PPUDGH6WDLQHVV6WHHO
HHDGGULYHP
PPSUHGULOOGHROHV
2YHUVLHGRHOVIRUJLDMXWPHW
DETAIL | 3DHOWR3DHOJLHWDLO



A diagram of a double door system. It features two vertical bars, one on the left and one on the right. The left bar is labeled with a circled '1' at both the top and bottom. The right bar is labeled with a circled '2' at the top. A diagonal brace connects the bottom of the left bar to the top of the right bar. The space between the bars is filled with vertical lines, representing the door panels. The entire assembly is mounted on a horizontal base.

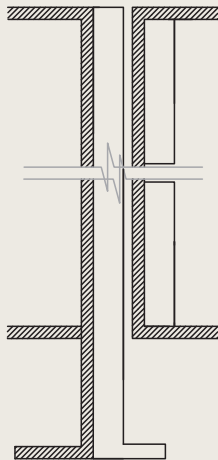

Diagram illustrating the components and dimensions of a vehicle barrier system:

- Barrier:** A vertical structure with a vehicle icon at the top.
- Dimensions:**
 - Barrier height: 300
 - Barrier width: 220
 - Barrier base width: 980
 - Barrier base height: 1200
 - Barrier base depth: 1285
 - Barrier base to top of latch knob: 1500 MIN.
- Labels:**
 - GATE
 - FENCE

2) GATE LATCH | DWHDWFDWDOODWLRQ

SOEEDWFDGDDWHVDFHVVRLHVWREHLQWDOOHGLQFFRUGDEHJW6ZPPL6RROV6DIHW6WDGDUG6HW



					1002	1002	1002	1002	-	-	-	-
WHO SD					1002	1002	1002	1002	-	-	-	-
)XHGHC HCGSDPPV												
	B	\$	%	(P	\$	%	&	(P	&	&	1P	&
WEHU'									-	-	-	-
WHO SD									-	-	-	-
)XHGHC HCGSDPPV												
	B	\$	%	(P	\$	%	&	(P	&	&	1P	&
WHO SD									507	507	507	-

HWWPEHDAWRHMGVKEH



FNCE

fnce.com.au

© 2022-2024 FNCE Pty Ltd

